

ADULT AND PEDIATRIC ADHESIVE SENSORS

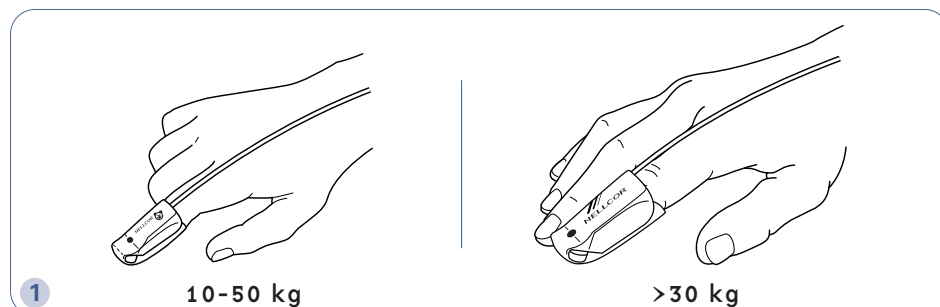

An index finger is the preferred sensor site. Alternatively, apply the sensor to a smaller finger, thumb or great toe. Use the pediatric sensor for pediatric patients weighing 10 to 50 kg. Use the adult sensor for adults weighing more than 30 kg.

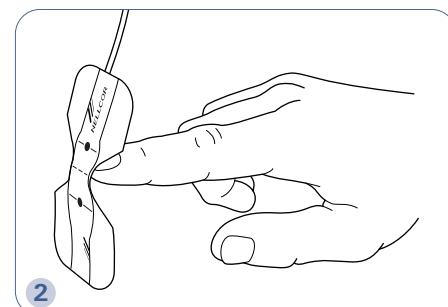

Remove the transparent backing from the sensor. Locate window and alignment marks. Orient the sensor so the dashed line is centered on the tip of the digit and the windows oppose each other.

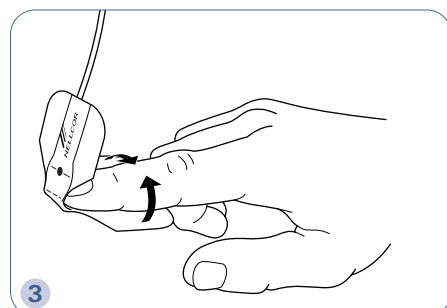

Apply the noncable half of the sensor to the bottom of the digit, and wrap the adhesive flaps around the sides of the digit.

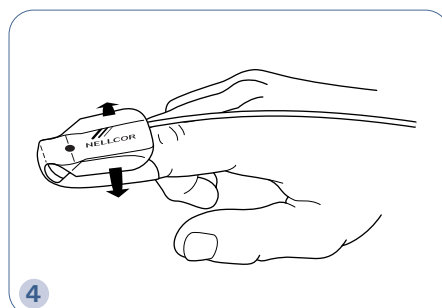

Fold the cable end of the sensor over the top of the digit. Wrap the adhesive flaps around the sides of the digit.

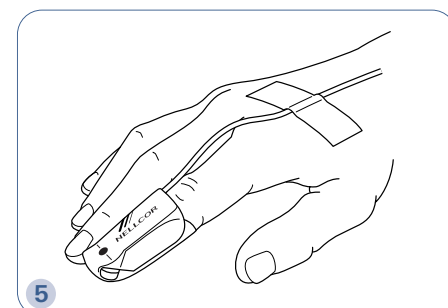

Anchor the sensor cable with a piece of medical-grade tape. Plug the connector end of the sensor cable into the patient cable attached to the monitor.

INFANT AND NEONATAL ADHESIVE SENSORS



Choose an infant sensor for patients who weigh 3 to 20 kg. Choose a neonatal sensor for patients who weigh less than 3 kg. Place the adhesive wrap on a flat surface, fabric side down. Remove the backing.

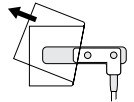

INFANT APPLICATION

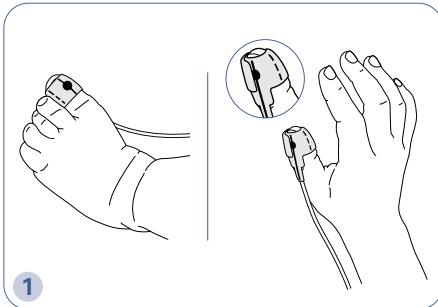

Select a sensor site. The preferred site is the great toe, with the cable running along the sole of the foot. Alternatively, apply the sensor to a thumb or other digit.

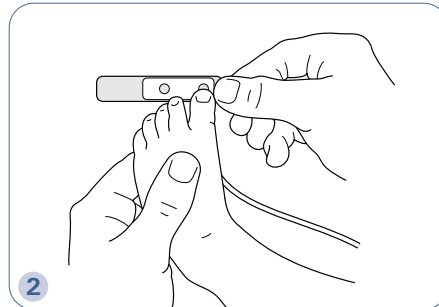

Position the sensor so the dashed line is centered on the lateral edge of the digit (see figure 1).

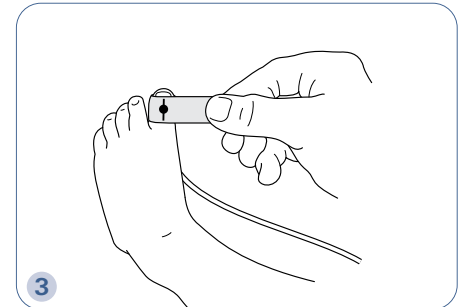

Wrap the sensor around the site, without stretching the tape, so the optical components directly oppose each other. Anchor the cable with a piece of medical-grade tape.

NEONATAL APPLICATION (For neonatal patients with especially fragile skin, consider using an *OxiMax® SoftCare™* Nonadhesive Sensor.)

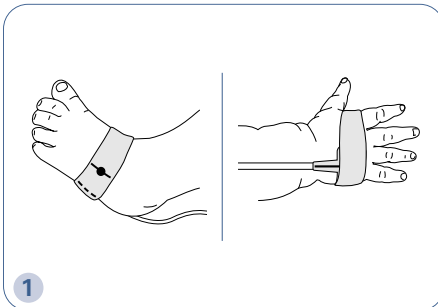

Select a sensor site. The preferred site is the foot below the toes, with the cable running along the sole of the foot. Alternatively, use the palm of the hand. Do not place sensor on the wrist or ankles.

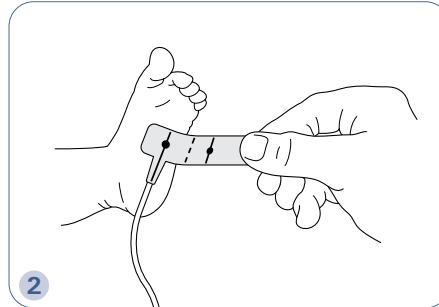

Position the sensor so the dashed line is centered on the lateral edge of the foot or hand.

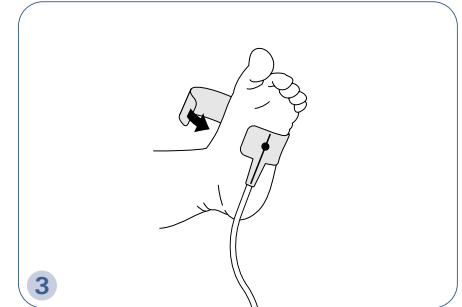

Wrap the sensor around the site, without stretching the tape, so the optical components directly oppose each other. Anchor the cable with a piece of medical-grade tape. Plug the connector end of the sensor cable into the patient cable attached to the monitor.

Check sensor site, including skin integrity, at least every 8 hours and change the sensor site as appropriate.

If you have any questions, contact your Nellcor representative or call 1-800-NELLCOR.



Read the sensor's "Directions for Use" insert for complete instructions for use, including all warnings, cautions and specifications, prior to use of this product.

tyco
Healthcare
Nellcor

4280 Hacienda Drive
Pleasanton, CA 94588
Tel 925.463.4000
Toll Free 1.800.635.5267
www.nellcor.com

Tyco Healthcare UK LTD.
154 Fareham Road
Gosport, UK PO13 0AS
Tel +44.1329.224000